

Courses & Distances
 S 66 E 87
 N 3 1/2 E 350
 N 4 1/2 E 88
 N 8 1/2 E 33
 N 3 1/2 E 105
 N 52 W 124
 S 35 W 586

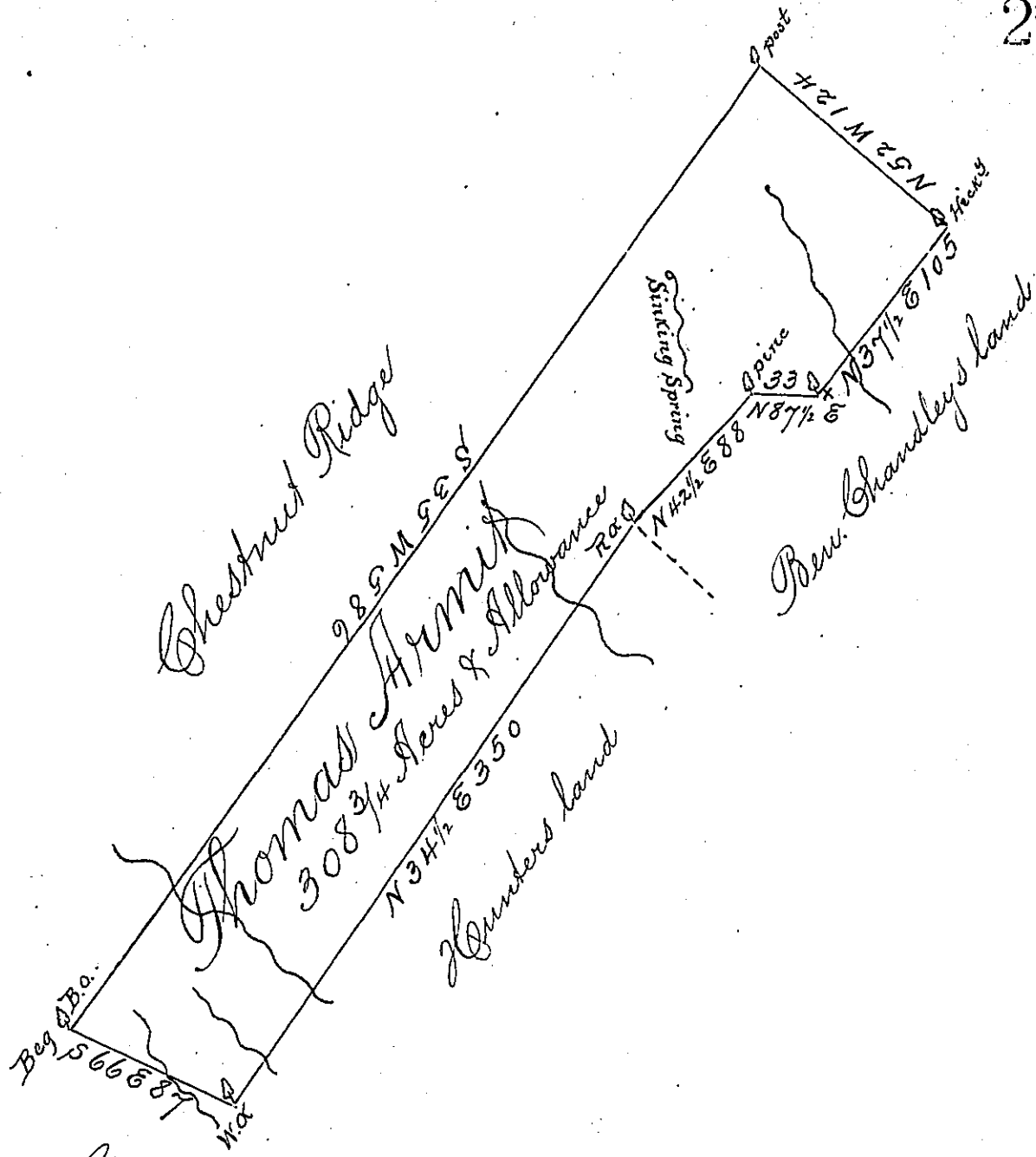

The Draught of a tract of land situate in the West end of Kishacoquillis Valley Cumberland County Containing three hundred & eight acres & nine tenths & the usual Allowance of Six p^{ts} Cent for Roads &c^a Surveyed for Thomas Armit Dec^r the first 1784 In Pursuance of a Warrant from His Excellency the President of the Supreme Executive Council Dated at Philadelphia Sept^r the 2^o 1784

p^r Jas^s Harris of

To John Lukens Esq^t }
 Surveyor General }

IN TESTIMONY that the above is a copy of the original remaining on file in the Department of Internal Affairs of Pennsylvania, made conformably to an Act of Assembly approved the 16th day of February, 1833, I have hereunto set my Hand and caused the Seal of said Department to be affixed at Harrisburg, this fourth day of March 1902

James W. Pitts
 Secretary of Internal Affairs.